

WooCommerce Product Import Plugin - Import Export Products in CSV

- by: Extendons
- extendons.com/
- email: info@extendons.com

1 Installation Guide

This is a quick guide on installation, and updating.

1.1 Plugin Installation

To install WooCommerce Product plugin you must have a working and latest version of WordPress and WooCommerce plugin already installed. For information on installing the WordPress, please see the [WordPress Codex - Installing WordPress](#). For installing the WooCommerce and configure the shop please visit the following link [WooThemes - Installing WooCommerce](#).

- Now the next step is the **WooCommerce Product Import Plugin - Import Export Products in CSV**. In the full .ZIP archive you have downloaded from **Codecanyon.net** you will find file. This file is the installable .ZIP archive you can install via WordPress.

Now is time to install **WooCommerce Product Import Plugin - Import Export Products in CSV**, please read these steps carefully.

Installing from WordPress

Follow the steps bellow to install from WordPress Admin Dashboard

- Navigate to Plugins
- Click Install Plugins and click Add New
- Click the Upload Plugin button
- Navigate the .ZIP file on your computer and click Install Now
- When installation is done please click Activate to activate plugin

Installing using FTP

Follow the steps bellow to install using FTP

- Unzip the file to a desired location on your computer. These extracted files will be uploaded later via FTP
- Connect to your server via FTP (Use FileZilla or any other FTP client)
- Navigate to /wp-content/plugins/ server directory
- Locate the local directory where you have unzipped the ext_woo_abandoned_cart.zip archive
- Upload local folder /Extendons-woocommerce-Direct-checkout/ to remote /wp-content/plugins/
- To activate the newly installed plugin navigate to Plugins and click the Activate button within the **WooCommerce Product Import Plugin - Import Export Products in CSV**

1.2 Plugin Updates

Update from WordPress Admin

Follow the steps bellow to update from WordPress Admin Dashboard

- Navigate to Plugins
- Find the currently installed **WooCommerce Product Import Plugin - Import Export Products in CSV** and click Deactivate
- After deactivation click Delete to remove the old version (your saved setting will not be lost)
- Click Install Plugins and click Add New
- Click the Upload Plugin button
- Navigate the new version archive .ZIP on your computer and click Install Now
- When installation is done please click Activate to activate plugin

Update using FTP

Follow the steps bellow to update using FTP

- Unzip the new version archive .ZIP file to a desired location on your computer. These extracted files will be uploaded later via FTP
- Connect to your server via FTP (Use FileZilla or any other FTP client)
- Navigate to /wp-content/plugins/ server directory and delete the current plugin folde
- Locate the local directory where you have unzipped the new version archive .ZIP file
- Upload local folder to remote /wp-content/plugins/

2 User Guide

After installation of plugin, login to admin panel and flush your cache storage.

2.1 How to Import/Export Products

At the backend end go to **Product Import/Export**. Here you will find the Import & Export tabs as shown below. You can Import or Products in CSV Files here as per your requirements.

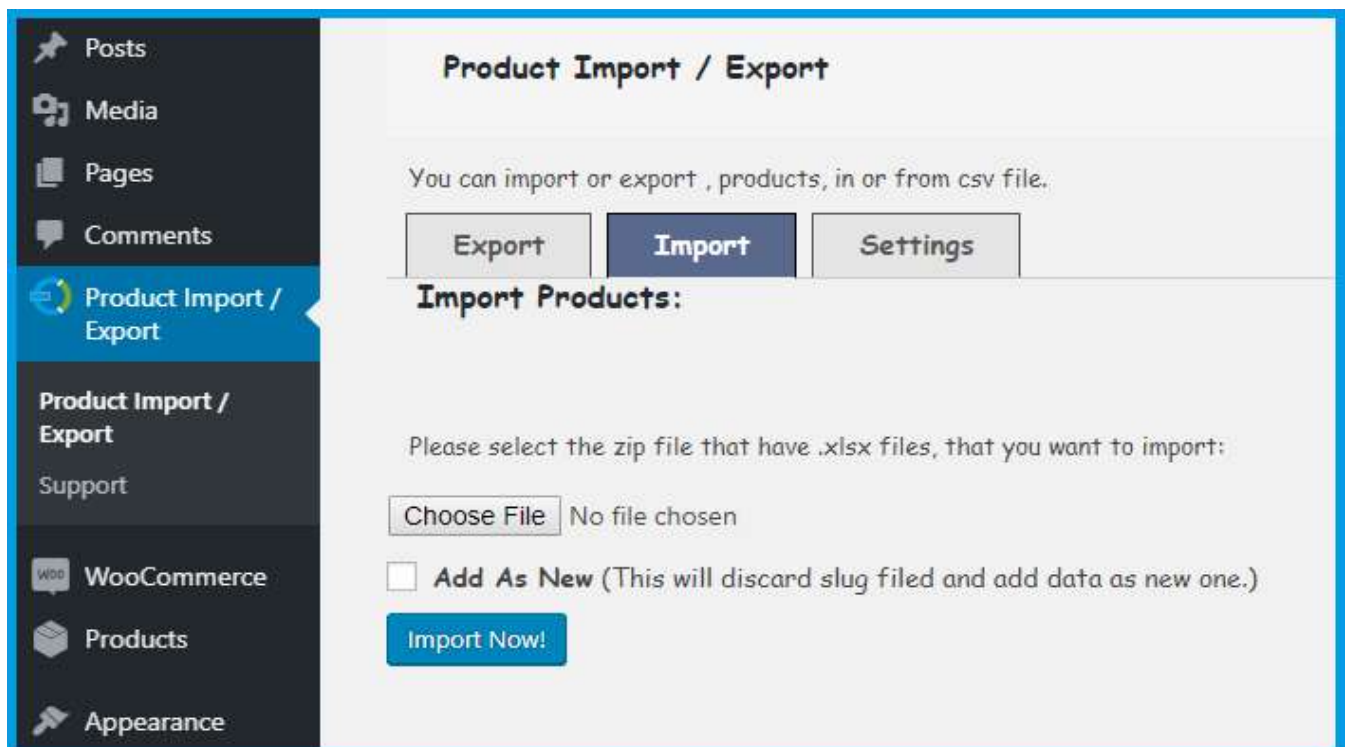
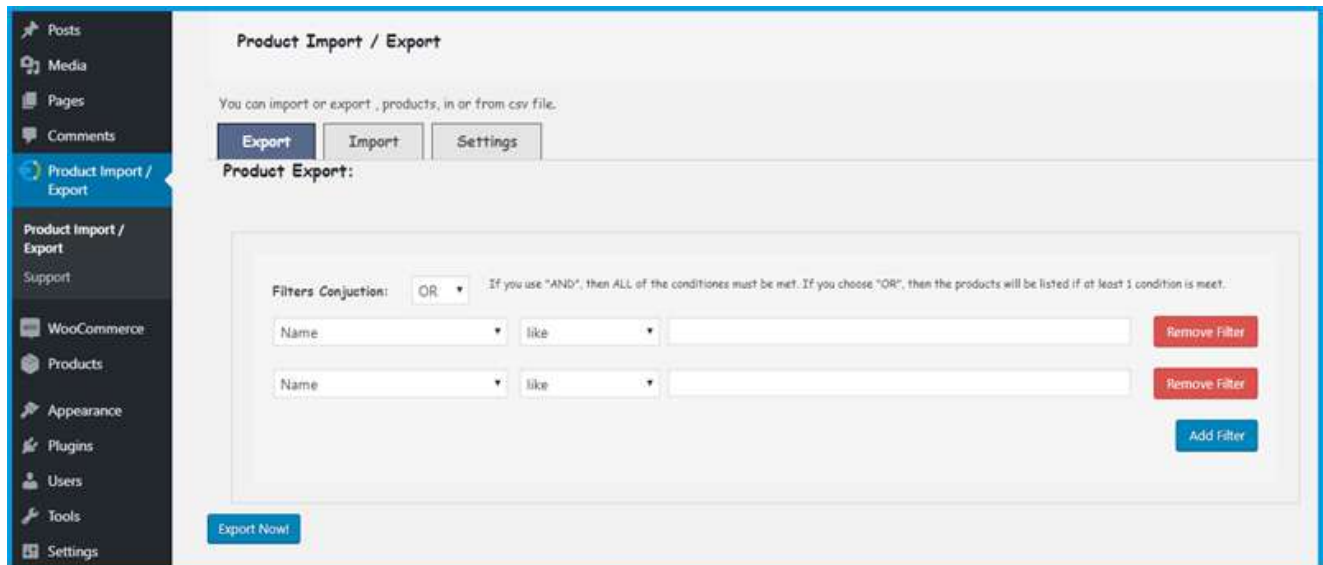

2.2 How to Configure the Plugin

At the backend, go to **Product Import/Export** and to the **Settings** tab. Here you will find the following settings:

Import / Export Settings:

- **Maximum entries on each exported part**
- **Maximum entries to read on each step of the import**

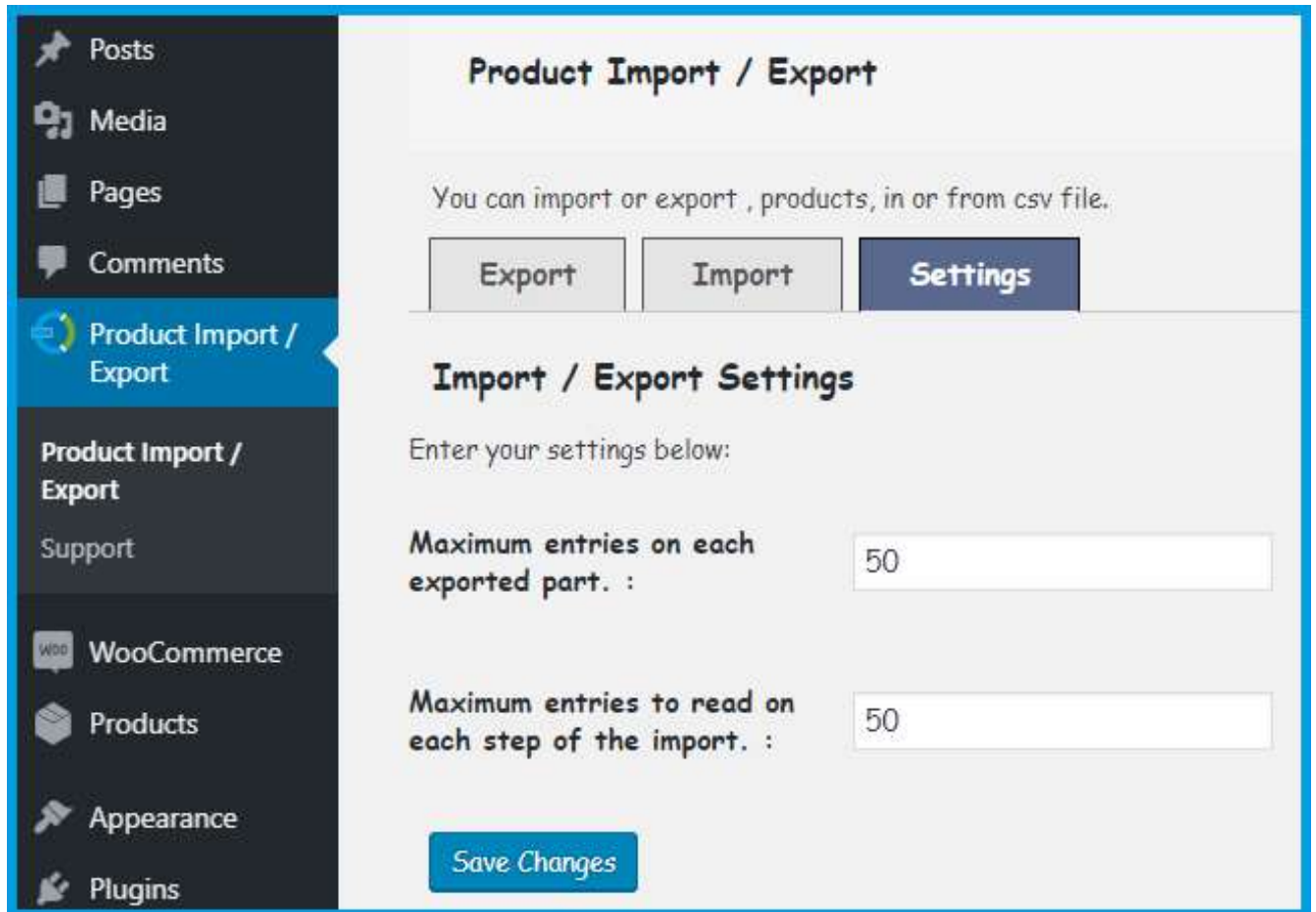

The screenshot shows the WordPress admin interface for the Product Import/Export plugin. On the left is a dark sidebar with navigation links: Posts, Media, Pages, Comments, Product Import / Export (highlighted in blue), Product Import / Export Support, WooCommerce, Products, Appearance, and Plugins. The main content area has a header 'Product Import / Export' and a sub-header 'You can import or export , products, in or from csv file.' Below this are three tabs: 'Export', 'Import', and 'Settings' (which is active and highlighted in blue). The 'Settings' tab contains the title 'Import / Export Settings' and the instruction 'Enter your settings below:'. There are two settings: 'Maximum entries on each exported part. :' with a text input field containing '50', and 'Maximum entries to read on each step of the import. :' with a text input field containing '50'. At the bottom of the settings area is a blue button labeled 'Save Changes'.

Product Import / Export

You can import or export , products, in or from csv file.

Export **Import** **Settings**

Import / Export Settings

Enter your settings below:

Maximum entries on each exported part. :

Maximum entries to read on each step of the import. :

Save Changes